

This Aroma diffuser uses Ultrasonic waves to instantly vaporize water and essential oil in the tank, to produce a cool, dry fragrant mist.

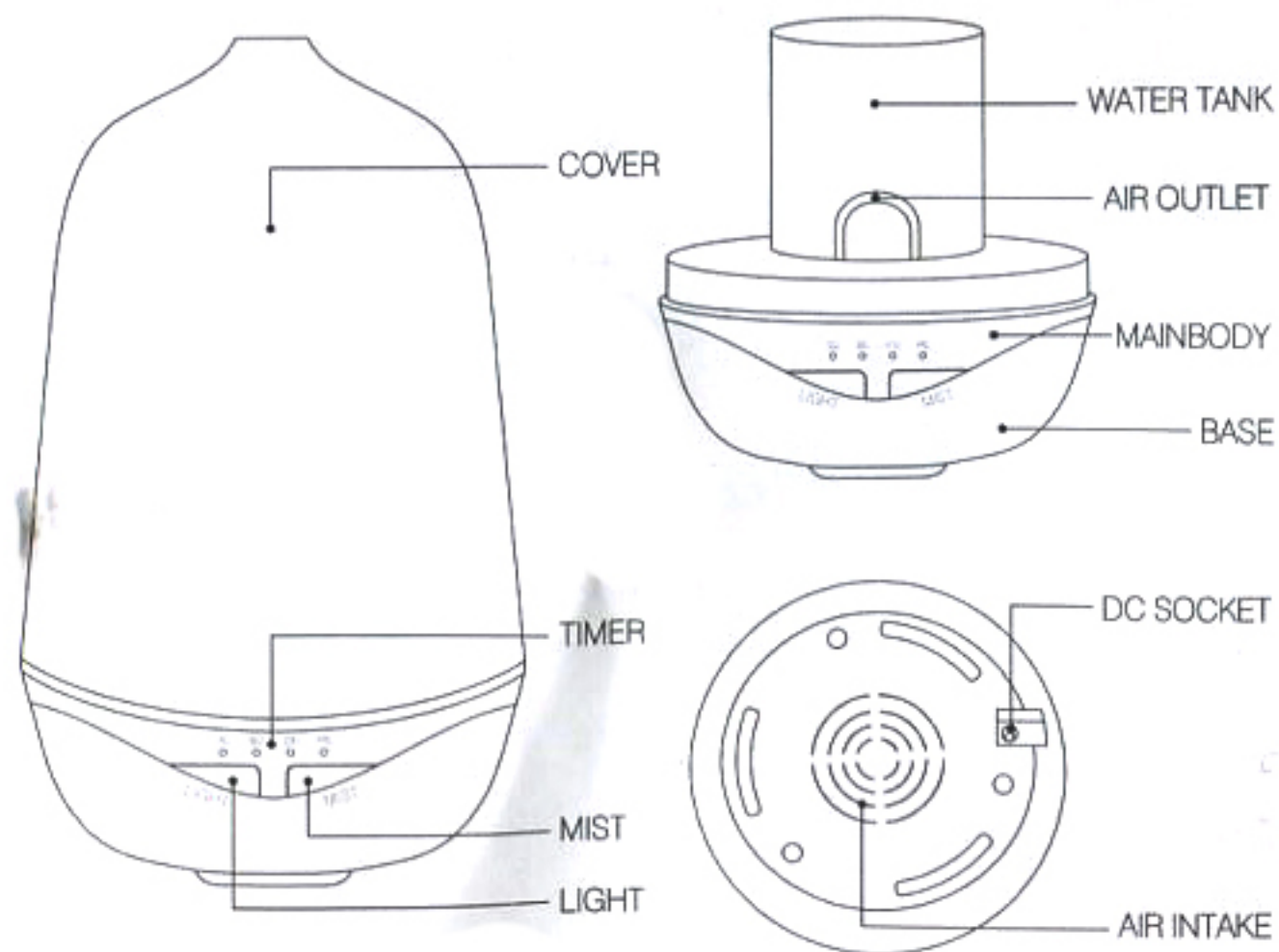

OPERATION

1. Please put the product upside, and remove the upper cover. FIG1
2. Please connect the AC adapter to the base of DC jack of the main body via cable guide. FIG2
3. Please fill in water into the water tank. Please take care, do not pour water out of water tank. FIG3

- Pay attention to the filled water level; **do not exceed the max line** on the water tank.
 - Water with high temperature and the mist may fly out, please **never fill in water during operating**.
4. Drop two drops of essential oil (about 0.1-0.15ML) into water tank vertically. FIG3
 5. Install the cover of the host with the original channel. Notes: The upper cover must be closed perfectly FIG4 (two cover matching points are vertically matched) when the device is in operation.
 6. Please connect the AC adapter with family user power supply socket.

7. If you press the MIST switch on main body of the product, mist function is on. You can set up the timer, each time you press down this button, the timer will be changed from 30 minutes, to 60 minutes, to 120 minutes, to 180 minutes and off FIG6

- When the power supply is connected, the original state is OFF.
- When there is no water or few water in the water tank, the power supply will automatic turn off immediately even with power connected.
- If time mode is off, LED light will be off at the same time.

8. If press the LIGHT button on, ON/OFF state of the LED light can be chosen.
9. If press LIGHT button for each time, the light color and lightness will be changed. FIG5
10. If not use for a long time, please drain out the water from the tank water, dry and keep it well. Before next use, please use the neutral detergent to clean the water tank again.

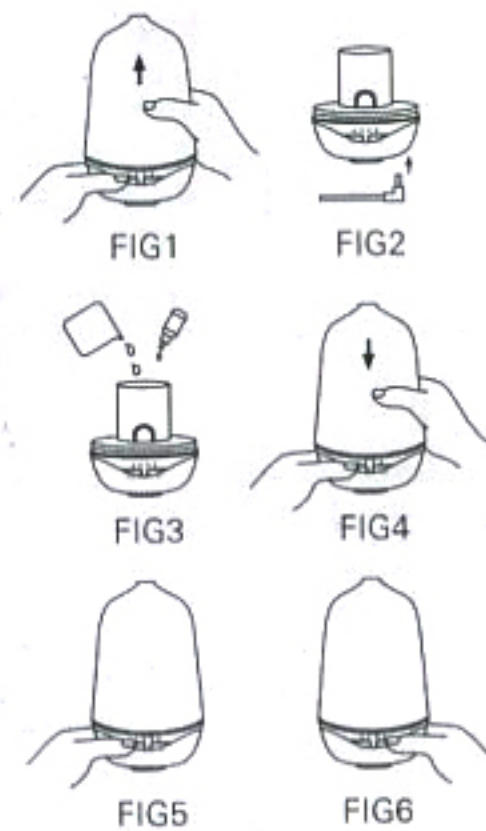

ATTENTION

- The amount and intensity of mist product will vary, but this is not unusual and should not be considered as a fault.
- Factors that affect this include water type, humidity, temperature, air currents.
- If there is no water in the water tank, press the MIST button will cause the device to "beep" 3 time to remind you to add water. The device will not work without water.
- Only 100% natural essential oil can be used in this device. Those containing chemical fragrance, spice or will cause malfunction. Use 2-3 drops per 100ML water a time. Too much oil will clog the system and cause malfunction. Please clean the device as per the maintenance instructions, before changing to use a new type of essential oil.

ACCIDENTAL LEAKAGE

In the event of the device being knocked over or tipped during use, please follow the steps as below to avoid malfunction.

- Unplug the device and remove cover
- Pour out any remaining water out of the water tank from.
- Shake the device gently to drain any water inside the mechanism, and the allow drying for at least 24 hours.

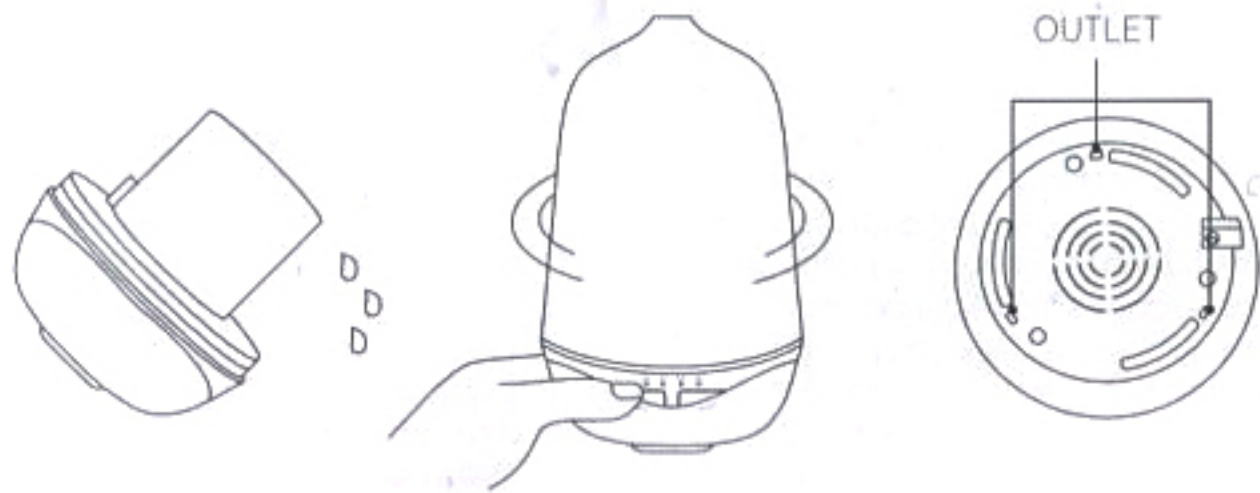

MAINTENANCE

After using 5-6 time, or 2-3 days, please clean the product as follows.

- Unplug the device from mains supply and remove cover.
- Pour out any remaining water from the "DRAIN SIDE" of the tank.
- Unplug power cord from base of device.
- Put 1 tablespoon of citric acid in the water tank, add just under 70ML of warm water (up to 70 degree)
- Leave for 5 minutes, and then drain solution from the "DRAIN SIDE" of the tank.
- Wipe with a soft cloth, avoid Ultrasonic Vibration plate area, which can gently cleaned with a cotton bud.

Never use other acids, enzymes or detergents, as this may risk poisonous gas to be created or cause malfunction.

Cover has an inner cover that can also be removed for cleaning.

1. Pull grip as indicated in the diagram to release.
2. After cleaning inner cover, replace by holding grip, and pressing down inner and outer cover until "click" is heard.

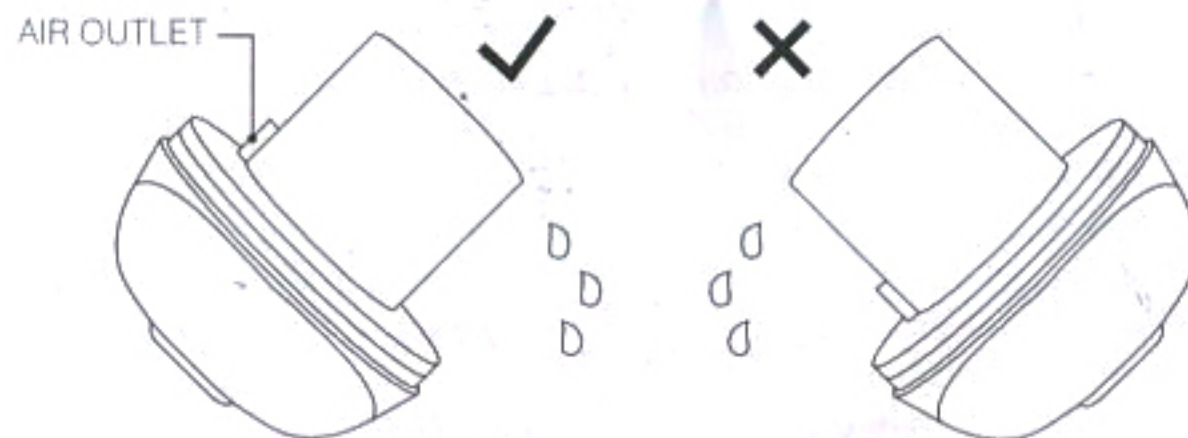

PRECAUTIONS

Please check below to avoid malfunction of the device.

- Do not fill the water over the MAX LINE at any time.
- Do not switch on power when the tank is empty.
- Do not touch the Ultrasonic Vibration plate.
- Clean regularly as per Maintenance instructions to avoid malfunction.
- Always unplug from power supply before maintenance.
- For hygiene reasons, after used, pour away remaining water from "DRAIN SIDE" of the tank and wipe with a clean dry cloth.
- Essential oils can stain. In the event of spillage of contact, please wipe away with a soft cloth.
- Do not let mist blow directing onto furniture, clothing, water etc.
- Keep away from electronic equipment, such as TV and Audio equipment.
- Do not tip the product, this may cause water to enter the mechanism and cause malfunction.
- Do not use for more than 3 hours any time. Wait 60 minutes before restart to avoid damage to Ultrasonic plate.
- Use tap water only, do not use mineral water, sparkling water etc.
- The amount and intensity of mist produced will vary, but this is not unusual and should not be considered as a fault.
- Factor that affect this includes water type, humidity, temperature, air currents.
- Never move the device when it in operation
- Do not touch any part of the device when wet hands.
- Keep out of reach of children and pets. Also, children being supervised not to play with the device. Appliance is not to be used by children or person with reduced physical, sensory or mental capabilities, or lack of experience and knowledge, unless they have been given supervision or instruction.
- Keep cord clear of pathways, and do not pull forcefully at any point.
- If smoke or burning smell is detected, unplug the device immediately.

TROUBLESHOOTING

Please refer to the table below in the event of the device operating abnormally.

Symptom	Possible Cause	Solution
Will not switch on switch off early	<ul style="list-style-type: none"> • Is there enough water in the tank? • Is the power cord connected properly? 	Disconnect, check cables and re-connect carefully.
No mist or abnormal mist	<ul style="list-style-type: none"> • No enough water? • Too much water? • Dirt on the ultrasonic plate? • Cover and inner cover are not install properly? • Dirt on the air suction port on the underside the base? 	Add suitable amount of water in the tank. Water must never be filled over the MAX line. Please refer to Maintenance instructions, remove and re-install correctly, so vapors can be release freely. Clean the air suction port of any dust. Restricted airflow will affect mist.
Water leakage from product	<ul style="list-style-type: none"> • Cover and inner cover are not install properly? • Has the device been tipped over? • Low temperature or high humidity. 	Remove and reinstall correctly, so vapors can be release freely. Follow accidental leakage instructions. Under these conditions, the mist may condense quickly into water droplets.

SPECIFICATIONS

Model:A750

Dimensions:105x105x170 mm

Input voltage:AC100-240V 50/60Hz

Out voltage:DC12V 1000mA

Mist Amount:20ML/H

Tank capacity:Max 100 ml

Appearance:Stripe/Frosting

Weight:200g

Materials:PP Plastic

Power:2W

Time model:30/60/120/180 min

Protection: 12V Adapter Anti-dry protection